

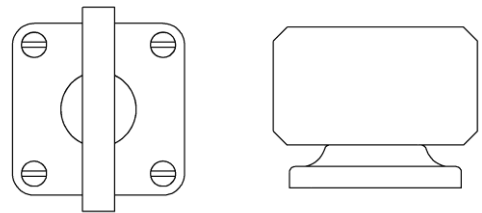

► **THUMBTURN HT1020 - BACKPLATE HT3190v**

The HT1020 rectangular thumbturn with chamfers provides a minimal look and can be paired with a variety of backplates.

See HT3190v for additional backplate information.



THUMB	L x W	BACKPLATE L x W	PROJECTION
1-3/16" x 3/16"		1" square	7/8"