

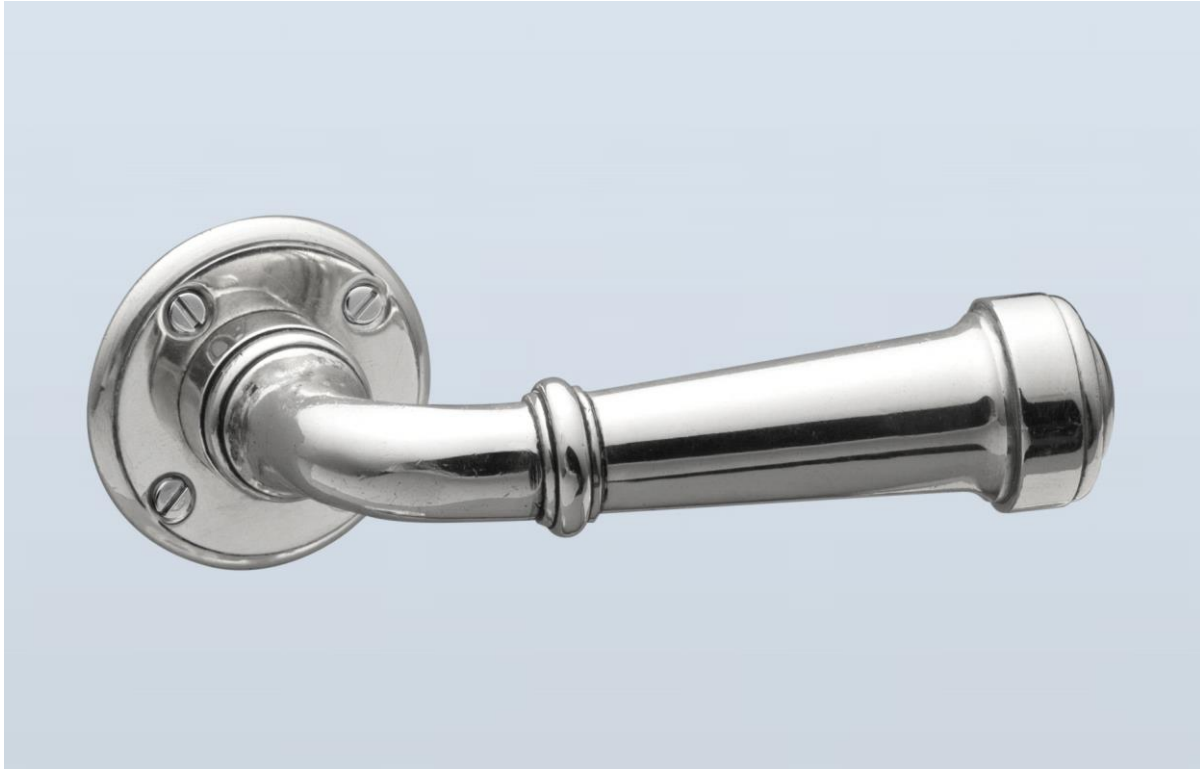

H . T H E O P H I L E

SINCE 1882



► **LEVER HT6025 - BACKPLATE HT3281v**

The HT6025 lever follows traditional Georgian models; this antique design is notable for its crisp and robust rendering of the handle's astragal and banded moldings.

The HT3281v rosette is also available without visible mounting screws. See HT3281v for additional backplate information.

LEVER LENGTH	BACKPLATE	PROJECTION
4-1/16" overall	1-13/16" diameter	2-3/4"