

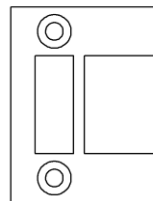

► **ROLLER LATCH HT7431**

The HT7431 heavy duty roller latch is used to hold dummy function swing doors in place when closed. It features concealed screws on the latch and is available in standard and custom finishes.



STRIKE

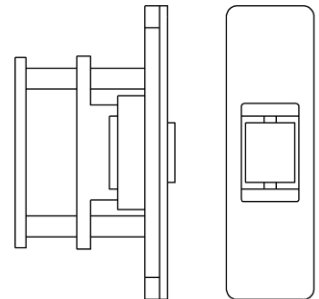

FACEPLATE	LATCH DEPTH	STRIKE PLATE
3-3/8"x 1"	1-11/16"	2-1/4 x 1-11/16"