



► WIRE PULL HT9006

The HT9006 wire pull is a simple and clean design suitable for a variety of interiors. Available with the option of a two-tone finish (as shown) or in one finish. Specify when ordering.

Available in standard and custom sizes. Most H. Theophile wire pulls can be custom sized for use as appliance pulls.

See HT9140 for a similar design.

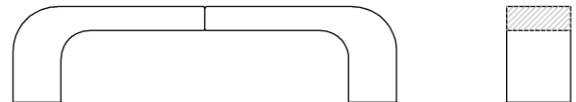

LENGTH	C-TO-C	WIDTH	PROJECTION
6"	5-1/4"	1"	1-1/2"

