

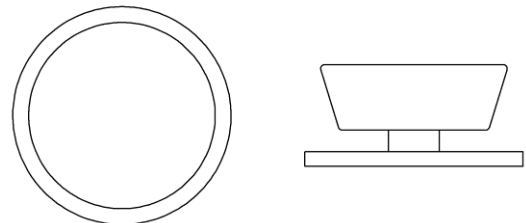

► **CABINET PULL HT9233 - BACKPLATE HT3001**

The HT9233 is a flattened flare cabinet pull with cylindrical shaft, shown with HT3001 backplate. Size shown is 1-5/8" pull with 1-7/8" round backplate.

See HT5402 for coordinating door knob sizes of this pull.



PULL	BACKPLATE	PROJECTION
1-5/8" diameter	1-7/8" diameter	7/8"