

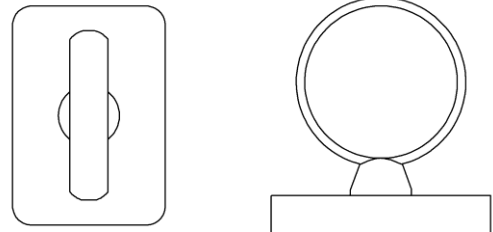

► **CABINET PULL HT9236 - BACKPLATE HT3105**

The HT9236 is a concave round key cabinet pull based on an antique design, shown here with HT3105 radiused backplate. Size shown is 1-1/8" pull with 1-7/16" long backplate.



PULL	L x W	BACKPLATE L x W	PROJECTION
1-1/8" x 1/4"		1-7/16" x 1-1/16"	1-9/16"