

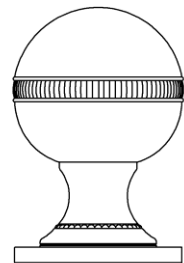

► CABINET PULL HT9313 - BACKPLATE HT3101v

This traditional cabinet pull was originally used on gun cabinets from an English country house. The knurling and beading on the base lends fine decorative detailing to this pull. Shown here with HT3101v backplate. Size shown is 1-3/8" pull with 1-3/8" square backplate at 2-1/8" total projection.

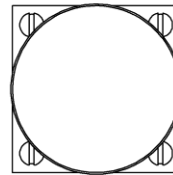

PULL	BACKPLATE	PROJECTION
1-1/8" diameter	1-1/8" square	1-3/4"
1-3/8" diameter	1-3/8" square	2-1/8"