

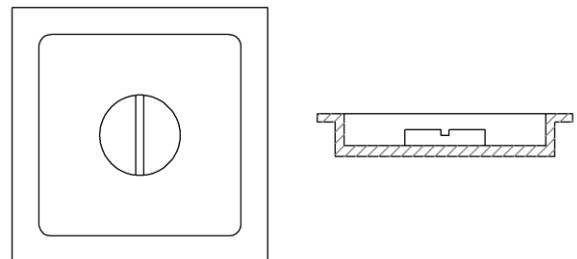

► RECESSED PULL HT9460e

This minimal recessed pull HT9460e is fitted with an emergency release turnpiece and is typically specified for sliding pocket doors. It is available as a plain recessed pull, with a thumbturn, emergency release button, or keyed cylinder. Please specify either polished or matte finish for interiors.

Standard box depth (mortised depth behind face frame) is shown.



LENGTH	WIDTH	PROJECTION	BOX DEPTH
2"	2"	1/16"	5/16"