

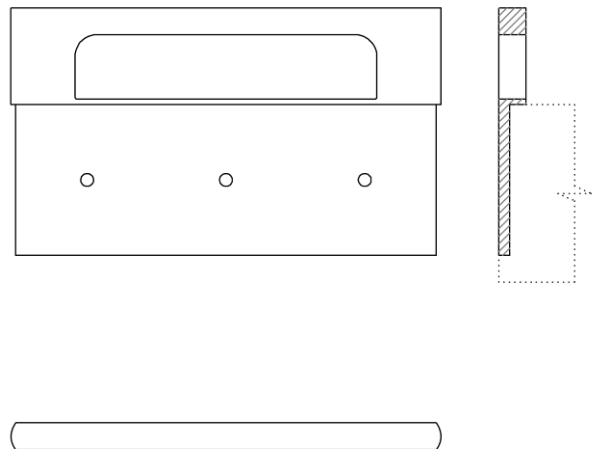

► **EDGE PULL HT9528**

The HT9528 edge pull is a clean, minimalist design.

The flange mortises flush into the edge of the door or drawer and is available in standard and custom sizes to suit various door and cabinetry applications.



LENGTH	WIDTH	PROJECTION	FULL DEPTH
5"	5/16"	1-1/8"	2-7/8"